

# Aluminium Edge Profiles

## 3mm Wrapped Edge For 19mm Board

aluminium anodized

| Cat No.        | Length (mm) | Finish |
|----------------|-------------|--------|
| 4131.39.019    | 2500*       | black  |
| 4131.38.019    | 2500*       | clear  |
| 4131.38.019.30 | 3000        | clear  |

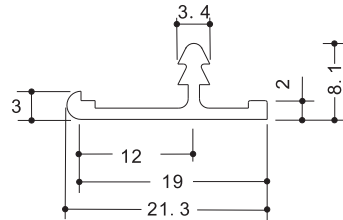
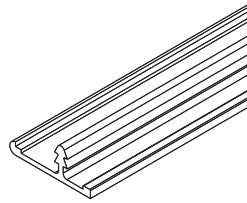

## 2mm Flush Edge For 19mm Board

aluminium anodized

| Cat No.     | Length (mm) | Finish |
|-------------|-------------|--------|
| 4268.39.019 | 2500*       | black  |
| 4268.38.019 | 2500*       | clear  |

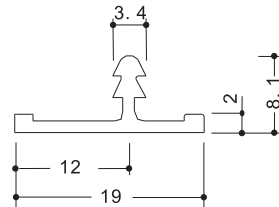
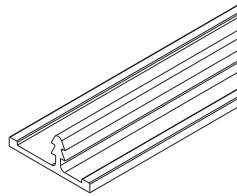

## 3mm Flush Edge For 25mm Board

aluminium anodized

| Cat No.     | Length (mm) | Finish |
|-------------|-------------|--------|
| 4268.39.025 | 3700*       | black  |
| 4268.38.025 | 3700*       | clear  |

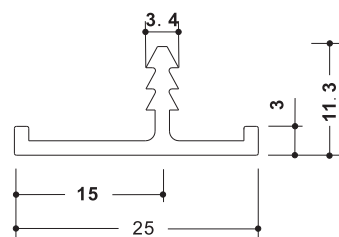
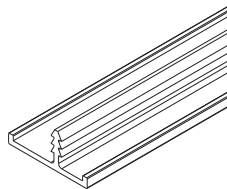

## 25mm Edge Corner

zinc alloy, plated

| Cat No.     | R | Finish       |
|-------------|---|--------------|
| 4268.39.001 | 0 | black        |
| 4268.43.002 | 0 | satin chrome |
| 4268.39.002 | 3 | black        |
| 4268.43.002 | 3 | satin chrome |

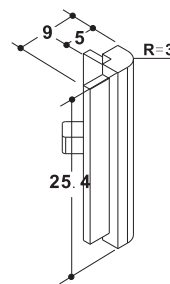
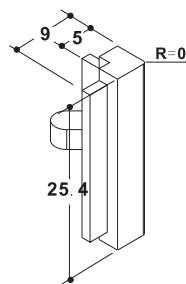

## Router Bit

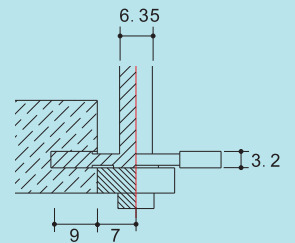
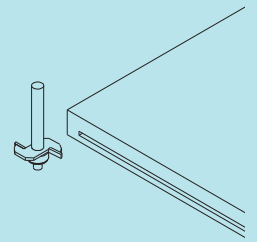

3.2mm slot bit 1/4" Shank  
32mm diameter with bearing

Cat No. 0140.15.032

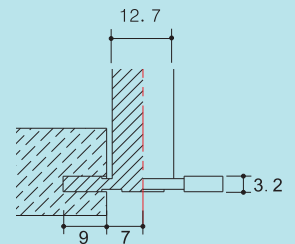

3.2mm slot bit 1/2" Shank  
32mm diameter no bearing  
for CNC

Cat No. 0141.00.032

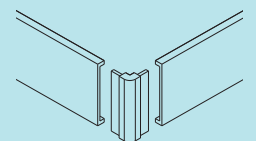

Dimensional Data not binding.  
We reserve the right to alter  
specifications without notice.

\* Usable length 2430~2470mm

\*\* Usable length 3630~3670mm